

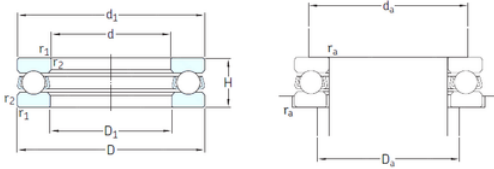

NTPT NTK BEARINGS CO.,LTD.



SKF 51101 Bearing

Bearing No. 51101

51101 Bearing 2D drawings and 3D CAD models

Size	12x26x9 mm
Bore Diameter	12 mm
Outer Diameter	26 mm
Width	9 mm
d	12 mm
D	26 mm
H	9 mm
d1	26 mm
r1 min.	0,3 mm
r2 min.	0,3 mm
D1	13 mm
da min.	21 mm
Da max.	17 mm
ra max.	0,3 mm
Weight	0,022 Kg
Basic dynamic load rating (C)	10,4 kN
Basic static load rating (C0)	16,6 kN
Fatigue load limit (Pu)	0,62
Reference speed	9000 r/min
Limiting speed	13000 r/min
Category	Thrust Ball Bearing
Inventory	0.0
Manufacturer Name	SKF
Minimum Buy Quantity	N/A
Weight / Kilogram	0.026
Product Group	B00308



NTPT NTK BEARINGS CO.,LTD.

Rolling Element	Ball Bearing
Thrust Bearing	Yes
Single or Double Direction	Single Direction
Banded	No
Cage Material	Steel
Precision Class	ABEC 1 ISO P0
Component Description	Roller Assembly Plus Raceways
Other Features	Single Row
Long Description	12MM Bore 1; 13MM Bore 2; 26MM Outside Diameter; 9MM Height; Ball Bearing; Single Direction; Not Banded; Steel Cage; ABEC 1 ISO P0 Precision
Inch - Metric	Metric
Category	Thrust Ball Bearings
UNSPSC	31171507
Harmonized Tariff Code	8482.10.50.08
Noun	Bearing
Keyword String	Ball Thrust
Manufacturer URL	http://www.skf.com
Manufacturer Item Number	51101
Weight / LBS	0.058
Bore 1	0.472 Inch 12 Millimeter
Overall Height with Aligning Washer	0 Inch 0 Millimeter
Height	0.354 Inch 9 Millimeter
Outside Diameter	1.024 Inch 26 Millimeter
Bore 2	0.512 Inch 13 Millimeter
bore diameter:	12 mm
static load capacity:	16.6 kN
outside diameter:	26 mm
dynamic load capacity:	10.4 kN



NTPT NTK BEARINGS CO.,LTD.

overall width:	9 mm
maximum rpm:	13000 RPM
thrust bearing type:	Single-Direction
cage material:	Steel
outside diameter design:	Straight
fillet radius:	0.3 mm
separable or banded:	Separable
series:	511
precision rating:	ABEC 1 (ISO Class Normal)
d_1	26 mm
D_1	13 mm
$r_{1,2}$ min.	0.3 mm
d_a min.	21 mm
D_a max.	17 mm
r_a max.	0.3 mm
Basic dynamic load rating C	10.4 kN
Basic static load rating C_0	16.6 kN
Fatigue load limit P_u	0.62 kN
Minimum load factor A	0.0014
Mass bearing (including seat washer where applicable)	0.022 kg