

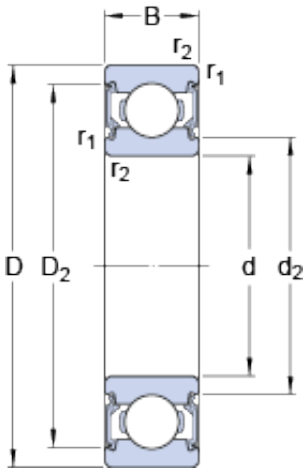

NTPT NTK BEARINGS CO.,LTD.



6000-2RSLTN9/Hybrid Deep Groove Ball Bearing 2D drawings and 3D CAD models

6000-2RSLTN9/Hybrid Deep Groove Ball Bearings

Bearing No. 6000-2RSLTN9/Hybrid Deep Groove Ball Bearings

Size	26x10x8 mm
Bore Diameter	26 mm
Outer Diameter	10 mm
Width	8 mm
d	10 mm
D	26 mm
B	8 mm
d ₂	13 mm
D ₂	22.6 mm
d _a - min.	12 mm
d _a - max.	12.5 mm
D _a - max.	24 mm
r _a - max.	0.3 mm
Basic dynamic load rating - C	4.8 kN
Basic static load rating - C ₀	2 kN
Fatigue load limit - P _u	0.083 kN
Reference speed	85000 r/min
Limiting speed	45000 r/min
Calculation factor - k _r	0.025
Calculation factor - f ₀	12.4
Category	Single Row Ball Bearings
Inventory	0.0
Manufacturer Name	SKF
Minimum Buy Quantity	N/A



NTPT NTK BEARINGS CO.,LTD.

Weight / Kilogram	0.018
Product Group	B00308
Enclosure	2 Seals
Precision Class	ABEC 1 ISO P0
Maximum Capacity / Filling Slot	No
Rolling Element	Ball Bearing
Snap Ring	No
Internal Special Features	Silicon Nitride Rolling Element Electrical Insulated
Cage Material	Polyamide
Enclosure Type	Contact Seal
Internal Clearance	C3-Loose
Inch - Metric	Metric
Long Description	10MM Bore; 26MM Outside Diameter; 8MM Outer Race Width; 2 Seals; Ball Bearing; ABEC 1 ISO P0; No Filling Slot; No Snap Ring; Silicon Nitride Rolling Element Electrical Insulated Internal Special F
Other Features	Deep Groove Low Friction NBR Seal Hybrid Silicon Nitride Rolling Element WT Standard Grease
Category	Single Row Ball Bearing
UNSPSC	31171504
Harmonized Tariff Code	8482.10.50.68
Noun	Bearing
Keyword String	Ball
Manufacturer URL	http://www.skf.com
Manufacturer Item Number	6000-2RSLTN9/HC5C3W T
Weight / LBS	0.039



NTPT NTK BEARINGS CO.,LTD.

Inner Race Width	0 Inch 0 Millimeter
Outer Race Width	0.315 Inch 8 Millimeter
Bore	0.394 Inch 10 Millimeter
Outside Diameter	1.024 Inch 26 Millimeter
bore diameter:	10 mm
static load capacity:	1.96 kN
outside diameter:	26 mm
precision rating:	Not Rated
overall width:	8 mm
finish/coating:	Uncoated
bore type:	Round
cage material:	Fiberglass Reinforced Nylon
closure type:	Double Sealed
outer ring width:	8 mm
row type & fill slot:	Single Row Non-Fill Slot
fillet radius:	0.3 mm
internal clearance:	C3, C5
maximum rpm:	34000 RPM
operating temperature range:	-40 to +210 ° F
series:	60
dynamic load capacity:	4.75 kN
d_2	13 mm
D_2	22.6 mm
d_a min.	12 mm
d_a max.	12.5 mm
D_a max.	24 mm
r_a max.	0.3 mm
Basic dynamic load rating C	4.75 kN
Basic static load rating C_0	1.96 kN
Fatigue load limit P_u	0.083 kN
Calculation factor k_r	0.025
Calculation factor f_0	12.4



NTPT NTK BEARINGS CO.,LTD.

Mass bearing	0.018 kg
--------------	----------