

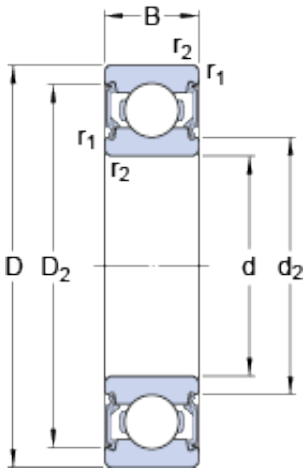

NTPT NTK BEARINGS CO.,LTD.



6201-2RSLTN9/HC5C3WT Bearing 2D drawings and 3D CAD models

6201-2RSLTN9/HC5C3WT SKF Hybrid Deep Groove Ball Bearings

Bearing No. 6201-2RSLTN9/HC5C3WT

Size	32x12x10 mm
Bore Diameter	32 mm
Outer Diameter	12 mm
Width	10 mm
d	12 mm
D	32 mm
B	10 mm
d ₂	16.6 mm
D ₂	27.4 mm
d _a - min.	16.2 mm
d _a - max.	16.5 mm
D _a - max.	27.8 mm
r _a - max.	0.6 mm
Basic dynamic load rating - C	7.3 kN
Basic static load rating - C ₀	3.1 kN
Fatigue load limit - P _u	0.132 kN
Reference speed	67000 r/min
Limiting speed	38000 r/min
Calculation factor - k _r	0.025
Calculation factor - f ₀	12.2
Category	Single Row Ball Bearings
Inventory	0.0
Manufacturer Name	SKF
Minimum Buy Quantity	N/A



NTPT NTK BEARINGS CO.,LTD.

Weight / Kilogram	0
Product Group	B00308
Enclosure	2 Seals
Precision Class	ABEC 1 ISO P0
Maximum Capacity / Filling Slot	No
Rolling Element	Ball Bearing
Snap Ring	No
Internal Special Features	Silicon Nitride Rolling Element Electrical Insulated
Cage Material	Polyamide
Enclosure Type	Contact Seal
Internal Clearance	C3-Loose
Inch - Metric	Metric
Long Description	12MM Bore; 32MM Outside Diameter; 10MM Outer Race Width; 2 Seals; Ball Bearing; ABEC 1 ISO P0; No Filling Slot; No Snap Ring; Silicon Nitride Rolling Element Electrical Insulated Internal Special
Other Features	Deep Groove Low Friction NBR Seal Hybrid Silicon Nitride Rolling Element WT Standard Grease
Category	Single Row Ball Bearing
UNSPSC	31171504
Harmonized Tariff Code	8482.10.50.68
Noun	Bearing
Keyword String	Ball
Manufacturer URL	http://www.skf.com
Weight / LBS	0.037
Bore	0.472 Inch 12 Millimeter
Outside Diameter	1.26 Inch 32 Millimeter



NTPT NTK BEARINGS CO.,LTD.

Inner Race Width	0 Inch 0 Millimeter
Outer Race Width	0.394 Inch 10 Millimeter
d_2	16.6 mm
D_2	27.4 mm
d_a min.	16.2 mm
d_a max.	16.5 mm
D_a max.	27.8 mm
r_a max.	0.6 mm
Basic dynamic load rating C	7.28 kN
Basic static load rating C_0	3.1 kN
Fatigue load limit P_u	0.132 kN
Calculation factor k_r	0.025
Calculation factor f_0	12.2
Mass bearing	0.037 kg